

S U P P L Y I N G C L E A N A I R T O I N D U S T R Y

Grind Master 1250

Downdraft Table

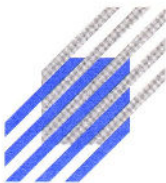

**AIR QUALITY
ENGINEERING**

7140 Northland Drive North, Brooklyn Park, MN 55428-1520 USA

FAX: (763) 531-9900 **EMAIL:** info@air-quality-eng.com **WEB SITE:** www.air-quality-eng.com

TOLL FREE: 1-800-328-0787

Air Quality Engineering Inc., has a policy of continuing product improvement and reserves the right to make changes in design and specification without notice.

Before you get started please review the following:

Purchase Date: _____

Serial Number: _____

Type of particulates collected: _____

Type of filter and AQE P/N: _____

Customer Technical Support:

To contact Air Quality Engineering use:

Mail: Air Quality Engineering
7140 Northland Drive N.
Brooklyn Park, MN 55428
USA

Phone: 1.800.328.0787
763.531.9823

Fax: 763.531.9900

e-mail: info@air-quality-eng.com

web: www.air-quality-eng.com

Copyright

Air Quality Engineering, Inc. copyrights this manual with all rights reserved. Under the copyright laws, this manual may not be reproduced in any form, in whole or in part, without the prior written consent of Air Quality Engineering, Inc.

© 2008

Disclaimer

All statements, technical information and recommendations in this manual or related documents are believed reliable, but the accuracy and completeness thereof are not guaranteed or warranted, and they are not intended to be, nor should they be understood to be representation or warranties concerning the products described.

Specifications are subject to change without notice.

TABLE OF CONTENTS

	PAGE
DIMENSIONS	4
SPECIFICATIONS	4
AIR CLEANING	5
OPERATION	6
SERVICE	7
ELECTRICAL SCHEMATIC	8
PARTS LIST	9
WARRANTY	10

DIMENSIONS

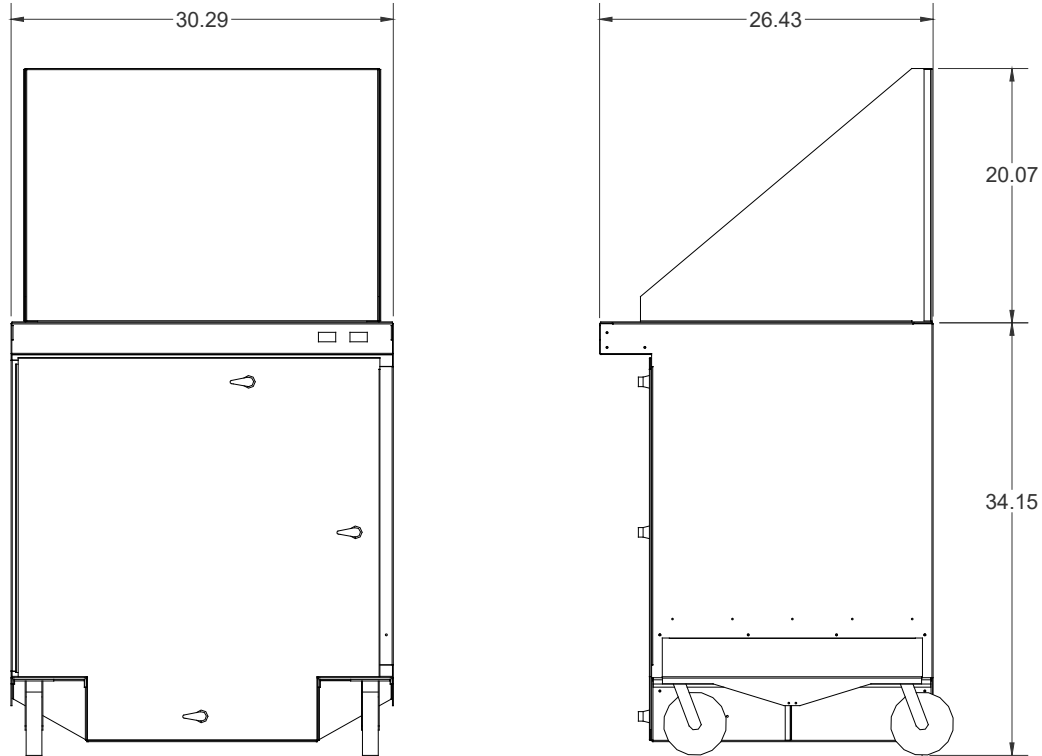

SPECIFICATIONS

- IMPORTANT -

THE SPECIFICATIONS GIVEN IN THIS PUBLICATION DO NOT INCLUDE NORMAL MANUFACTURING TOLERANCES. THEREFORE, THIS UNIT MAY NOT MATCH THE LISTED SPECIFICATIONS EXACTLY. ALSO, THIS PRODUCT IS TESTED AND CALIBRATED UNDER CLOSELY CONTROLLED CONDITIONS AND SOME MINOR DIFFERENCES IN PERFORMANCE CAN BE EXPECTED IF THOSE CONDITIONS ARE CHANGED.

SPECIFICATIONS

Dimensions: 30.31"W x 26.44"L x 54.25" tall

Weight: 210 Lbs. installed weight

Cabinet: 16 and 14 gauge welded steel cabinet with a powder coat finish. Top panel is made of 12 gauge galvanized steel.

Standard Blower: Backward curved, vibration-free, motorized impeller rated at 1250cfm @ 2" WG.

Vibration Motor: Heavy Duty Electrical Vibrator. Water tight, continuous duty. **115 Volt 50 or 60 Cycles, 3500 rpm, Standard 60 lbs. of Force**

Power Input: 1.08 kW motor, 120V, 60 Hz, single phase, 9.4 amps

Guards: 16 gauge galvanized steel removable panels.

Primary Filter: Cartridge with 80/20 FR media, 90 sq ft of media. Efficiency is 99.8% @ 0.5 micron.

Air Quality Engineering, Inc., has a policy of continuing product improvement and reserves the right to make changes in design and specifications without notice.

AIR CLEANING

INTRODUCTION

Clean air is the subject of numerous laws and regulations. Typical requirements in the United States are those put out by the Occupational Safety and Health Administration (OSHA). Private groups, such as the American Society of Heating, Refrigeration and Air Conditioning Engineers (ASHRAE), have also published numerous recommendations.

Normally, clean air is defined in regulations and recommendations as air having a limited amount of contaminant in it, commonly expressed as parts

per million or milligrams per cubic meter.

Approved counteractions are intended to lower or eliminate the amount of contaminants in the air. One of the more common methods of achieving this goal is through the use of media air cleaners.

At no time should a media air cleaner be placed where there is a potential for explosion due to the presence of explosive dusts, gases or vapors. Contact the nearest Air Quality Engineering, Inc., representative for assistance in determining the correct application of a media air cleaner.

DOWNDRAFT TABLE

Downdraft table is a self-contained portable filtration system that removes harmful **particulates**

and returns filtered air back into the facility with no external ventilation required.

APPLICATIONS

Utility Table, Buffing, Grinding, Welding, Powder Mixing, Spray Painting, Sanding, Soldering

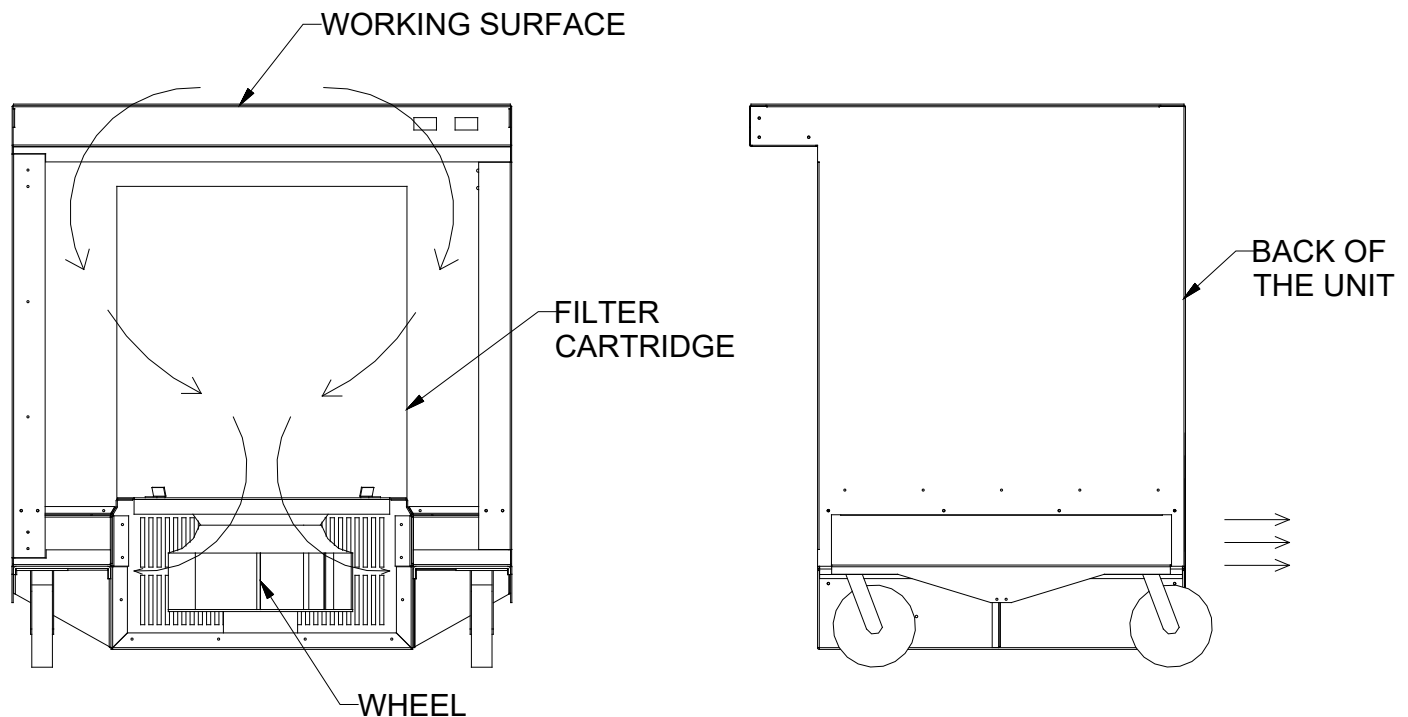

OPERATION

- CAUTION -

Do not mix combustible materials, such as aluminum, magnesium, paper or wood dust with potential ignition sources due to the potential fire hazard. Potential ignition sources include grinding ferrous metals or hot ash or slag. All users should comply with all National and Local Fire Codes.

DO NOT SWITCH BETWEEN GRINDING COMBUSTIBLE MATERIALS AND GRINDING FERROUS METALS DUE TO THE HIGH POTENTIAL FOR FIRE OR INJURY.

1. **This equipment should not be used for the collection of materials where there is a risk of explosion.**
2. Workers and machine operators should be instructed to keep any burning objects, such as cigarettes, safely away from air inlets.

3. All those involved with the use of this machine should comply with the statements regarding safety as noted in this manual.

UNPACKAGING INSTRUCTIONS

The Grind Master 1250 is packaged in one box.

1. Inspect the box for damage before signing the delivery receipt from the carrier. If the box appears to have been damaged, note the damage on the delivery receipt and have the carrier initial the note.
2. Carefully remove the packaging from the Grind Master 1250.

The Grind Master 1250 is equipped with a 10-foot power cord with a standard molded (15 amp rated) plug. Route the power cord so that it is out of the way of the building's occupants and so that it does not interfere with the machine's operation.

The location of vibration motor panel and bracket keepers for the operation and filter cleaning mode is shown below.

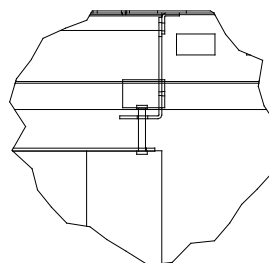
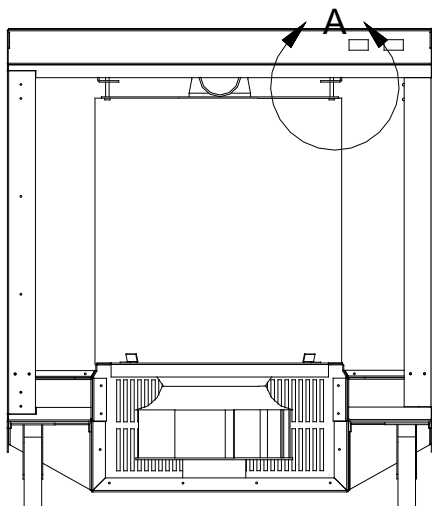

DETAIL A

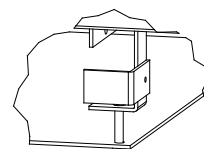
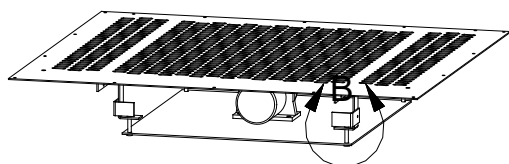

DETAIL B

SERVICE

CLEANING THE CARTRIDGE FILTERS

Use your own judgment for the time to clean the cartridge.

To clean the cartridge:

- Turn the blower motor off.
- Turn the vibrator motor on for two minutes
- Empty and reinstall the dust trays before operating the unit.

EXTENDING CARTRIDGE LIFE

1. Cartridge life can be extended by manually blowing out the cartridge filters.
2. To manually clean the filters, remove the cartridge from the Grind Master 1250 and blow the dust off using a handheld blowgun

attached to a shop air line. Airflow should be directed from the inside of the cartridge to the outside of the cartridge.

The location of vibration motor and bracket keepers is shown on the picture below

MAINTENANCE

The Grind Master 1250 will require minimum maintenance to keep it in good operating condition. The motor is totally enclosed with permanently lubricated ball bearings. No maintenance is required other than to clean the cartridges and general cleaning of the cabinet, as needed.

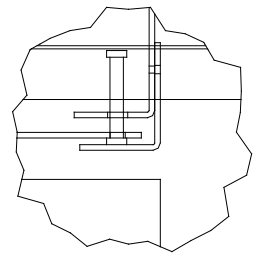
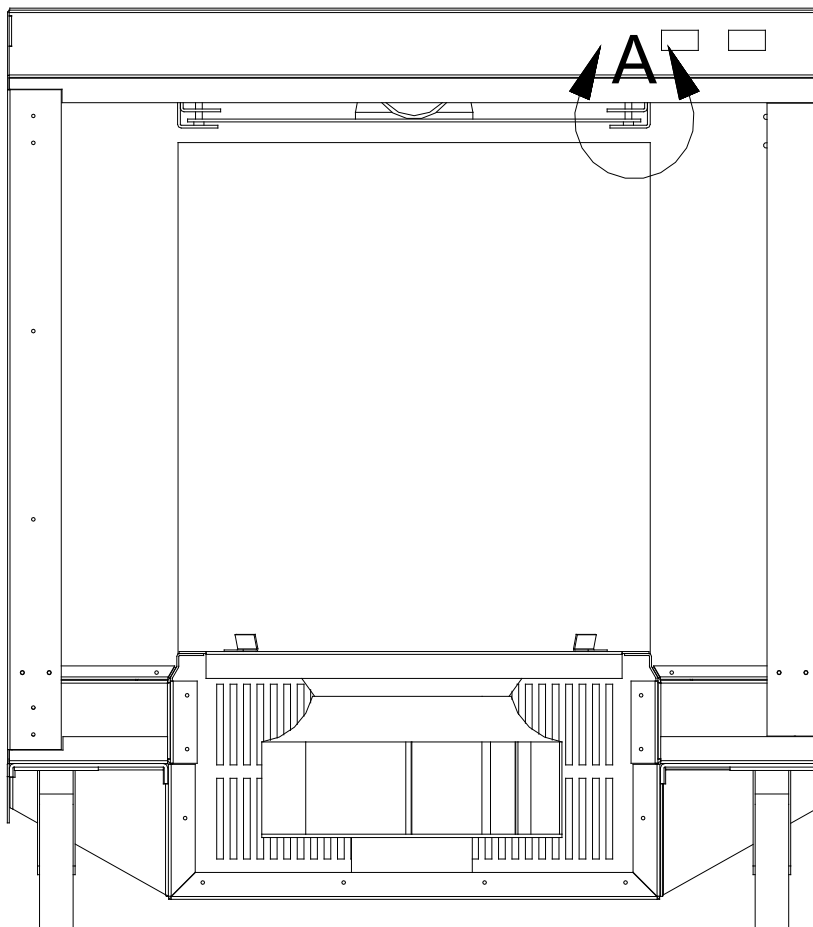

DETAIL A

ELECTRICAL SCHEMATIC

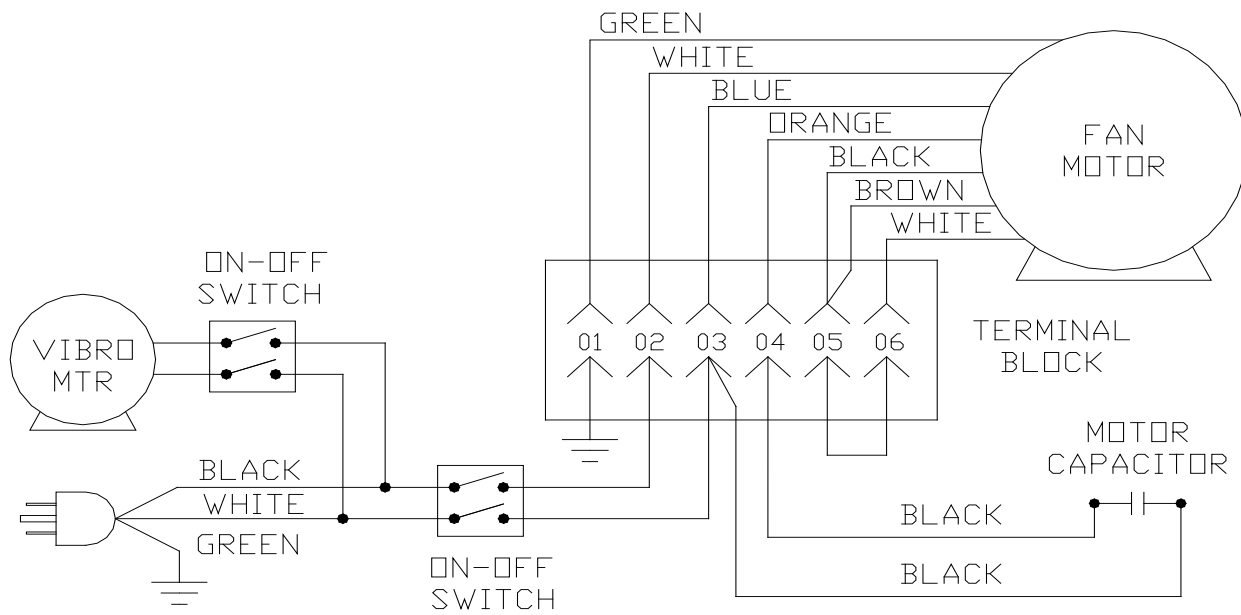

PARTS LIST

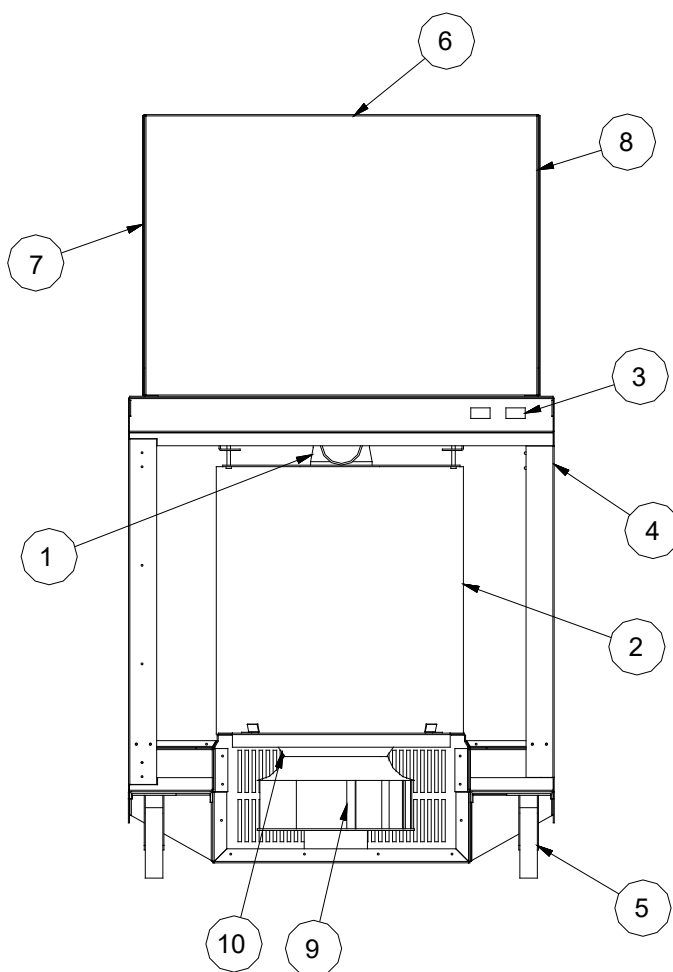

O.	DESCRIPTION	PART NO.
1	Electric vibrator 120V	40079
2	Filter Cartridge 90 SF 80/20	41247
3	Switch, McGill, On-Off (Qty 2)	10140
4	Cord, 10' Line, 120 V 14/3	42129
5	Caster, 5", Swivel, With Lock	30041
6	GMaster 1250 Back Panel Guard	22533
7	GMaster 1250 Side Panel Guard	22534
8	GMaster 1250 Right Side Guard	22534-1
9	Impeller Media MB 115V	40073
10	Inlet Cone for Blower Wheel	37043
Not shown	Capacitor 60 MFD 370 V	40122

CERTIFICATE OF WARRANTY

THREE-YEAR LIMITED WARRANTY

Air Quality Engineering, Inc. (AQE), warrants to the original purchaser, subject to the conditions below, that if the "Product" covered by this warranty should fail to perform by reason of improper workmanship or material, AQE will during the period of three (3) years from the date of original purchase either (i) replace the product or (ii) provide all necessary parts to repair the product without charge. The decision to replace the product or the necessary parts shall rest solely with AQE. This three-year limited warranty does not apply to main filter elements. AQE will replace without charge the main filter elements during the period of thirty (30) days from the date of original purchase if the main filter elements fail to perform by reason of improper workmanship or material. This warranty is valid only under the following conditions:

CONDITIONS

1. **REGISTRATION:** The purchaser's completion and mailing of the Registration Card to Air Quality Engineering, Inc., 7140 Northland Drive North, Minneapolis, Minnesota 55428-1520 within 30 days of original purchase.
2. **AUTHORIZATION:** The purchaser will contact AQE at (763) 531-9823 for authorization, returned goods number (RGA) and the shipping address. AQE will direct the purchaser to either return the necessary parts or the product at AQE's option.
3. **PROPER DELIVERY:** The shipping, freight prepaid or delivery of the parts or the product to AQE in either its original carton or in a carton assuring similar protection of the product with the returned goods number (RGA) clearly displayed on the outside of the carton.
4. **UNAUTHORIZED REPAIR:** A showing by the original purchaser that the product has not been altered, repaired or serviced by anyone other than an authorized service technician using genuine AQE parts.
5. **UNAUTHORIZED PARTS:** A showing by the original purchaser that the product has had only genuine AQE parts and filters used in its operation and maintenance.
6. **SERIAL NUMBER INTACT:** A showing by the original purchaser that the serial number has not been altered or removed.
7. **MISUSE:** A showing by the original purchaser that the product has not been involved in an accident, freight damaged, misused, abused or operated contrary to the instructions contained in the Owner's Manual.

Air Quality Engineering, Inc.'s, sole responsibility shall be to repair or replace the product within the terms stated above. AQE SHALL NOT BE LIABLE FOR ANY CONSEQUENTIAL DAMAGES RESULTING FROM ANY BREACH OF WARRANTY, EXPRESS OR IMPLIED, APPLICABLE TO THIS PRODUCT. Some states do not allow the exclusion or limitation of consequential damages so this limitation may not apply to you.

THIS WARRANTY IS IN LIEU OF ALL OTHER WARRANTIES, EXPRESS OR IMPLIED, AND THE WARRANTIES OF MERCHANTABILITY AND FITNESS FOR A PARTICULAR PURPOSE ARE HEREBY EXCLUDED BEYOND THE THREE-YEAR DURATION OF THIS WARRANTY. Some states do not allow limitations on how long an implied warranty lasts so the above limitation may not apply to you.

This warranty gives you specific legal rights and you may also have other rights that vary from state to state.

**AIR QUALITY ENGINEERING, INC.
7140 NORTHLAND DRIVE NORTH
MINNEAPOLIS, MINNESOTA 55428-1520**

**TOLL FREE: 1-800-328-0787
TELEPHONE: (763) 531-9823
FAX: (763) 531-9900**

MANUFACTURER & WORLDWIDE DISTRIBUTOR OF SMOKEMASTER® AIR CLEANING SYSTEMS