

S U P P L Y I N G C L E A N A I R T O I N D U S T R Y

MODEL M68 SOURCE CAPTURE HEPA Air Cleaner

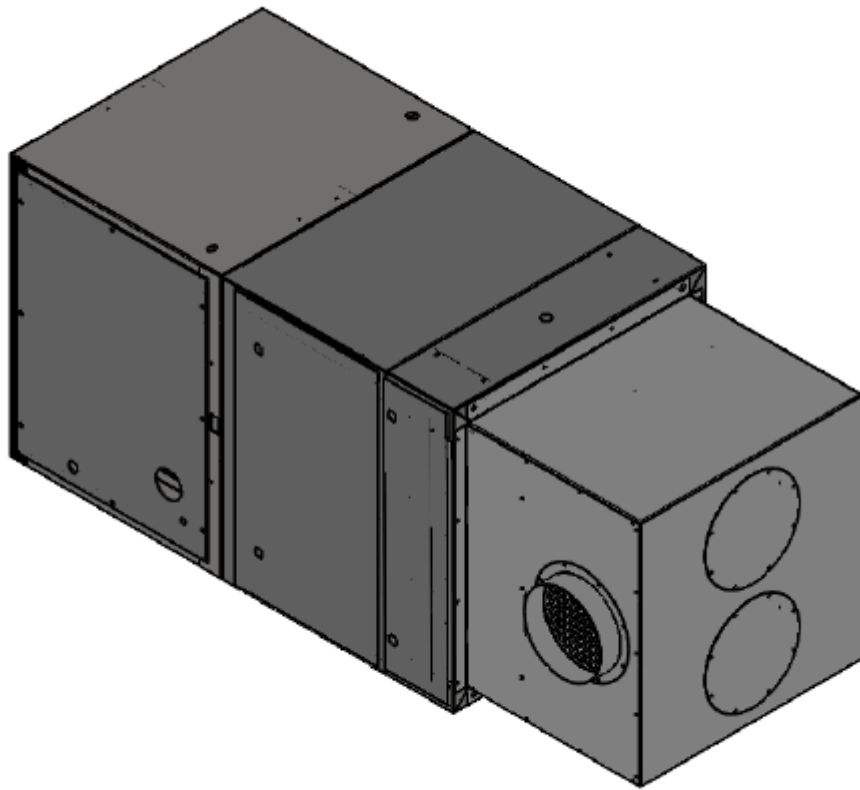

The M68 is a self-contained HEPA air cleaner rated at 99.97% efficient @ 0.3 microns. The M68 is designed for use where higher efficiency filtration is required and intended for source capture applications. The M68 is rated for airflows up to 1850 CFM.



AIR QUALITY
ENGINEERING

Manufacturer and Worldwide Distributor of Air Cleaning Systems for 30 years .

M68 FEATURES & SPECIFICATIONS

STANDARD FEATURES

- True HEPA filter rated 99.97% efficiency @ .3 microns
- Side load mechanical filter system for easy filter access
- 4-way adjustable louvers
- 10-foot power cord with molded plug on single phase units
- Quality engineering and workmanship backed by a 3-year parts warranty

OPTIONAL FEATURES

- Motor and fan upgrades
- Add on carbon or electrostatic modules
- Custom Plenums, ducting, and hood accessories

DIMENSIONS: 27.10"H x 26.5"W x 46"L or 48"L for Direct Drive Option

WEIGHT: 296 lbs. Installed
345 lbs. Shipping weight

CABINET: 16-gauge welded steel cabinet with ivory enamel finish.

POWER INPUT: **VOLTAGE** **PHASE** **1½ HP MTR AMPS**

110-120	1	17.2
208-240	1	8.8

MOUNTING: Unit may be mounted to ceiling with 3/8" - 16 NC

eyebolts included, or on wall with optional mounting hardware.

MOTOR: Heavy-duty 1 1/2 HP motor with sealed ball bearings.

BLOWER: Belt driven fan capable of 3000 CFM free air, with field adjustable motor sheave.

PREFILTER: 24" x 24" x 4", 35% efficient pleated media.

PRIMARY FILTER: 24" x 24" x 12", HEPA 99.97% certified efficiency @ .3 microns.

INSTRUMENTATION: Dirty Filter Gauge - Factory installed pressure gauge designed to determine filter replacement cycle.

SOURCE CAPTURE: A plenum that can fit various flange and hose sizes will be included.

FILTER ACCESS: Side load

SOUND LEVELS: Max 72 dBA at 15 ft., 74 dBA at 9 ft.

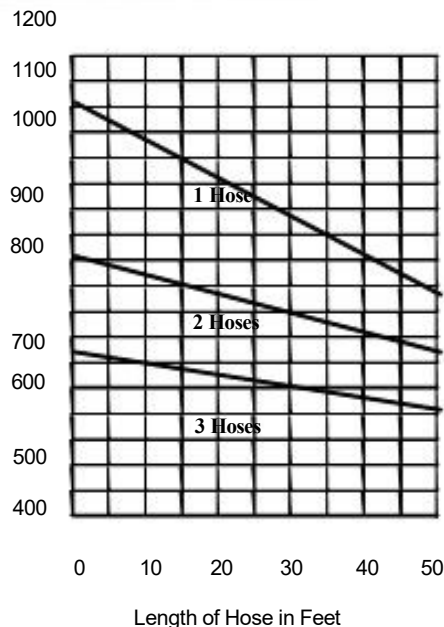

M68 with source capture plenum, 8" diameter hose and 1½ HP motor. (Motor sheave set at max. airflow)

This unit is to be used exclusively for source control in industrial applications in California.



**AIR QUALITY
ENGINEERING**

7140 Northland Drive North, Brooklyn Park, MN 55428-1520 USA

EMAIL: info@air-quality-eng.com **WEB SITE:** www.air-quality-eng.com

TOLL FREE: 1-800-328-0787 **PHONE:** (763) 531-9823

Air Quality Engineering Inc., has a policy of continuing product improvement and reserves the right to make changes in design and specification without notice.

LT-0020 A